

WATERPROOF MULTI TRIM

TRANSITION INSTALLATION

step
1

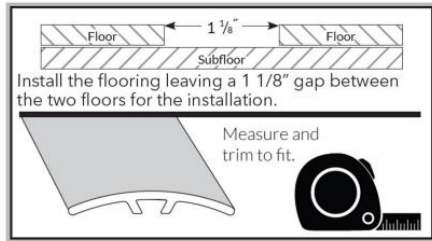

step
2

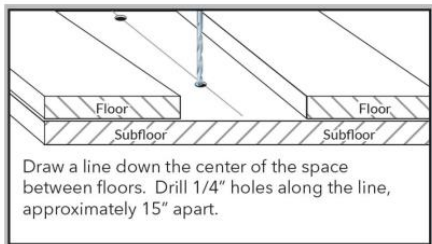

step
3

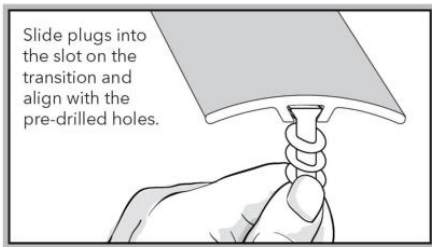

step
4

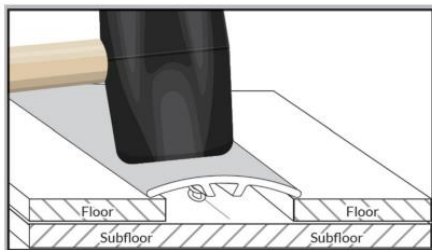

width: 1.6"
height: 0.23"
length: 94"

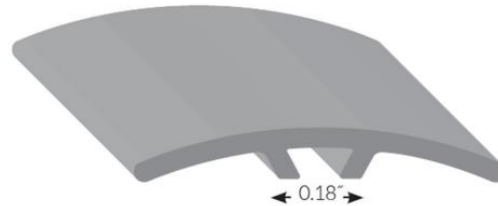
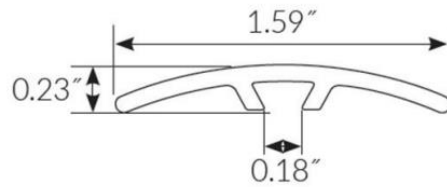

DESCRIPTION:

The multi-trim can be used for both floors of equal and unequal height. It automatically adjusts to varying heights allowing it to also be used as a surface reducer.

Automatically adjusts to varying heights.